

## Two-Way Linear Actuator Connectors

Aluminum, Multi Part Assembly, for One-Axis system

### SPECIFICATION

#### Identification no.

No. **2**: With 4 stainless steel socket cap screws DIN 912

Aluminum

Powder coated

Black, RAL 9005, textured finish **S**

Socket cap screws DIN 912

Stainless steel AISI 304

Hex nuts DIN 985

Stainless steel AISI 304

Self-locking via polyamide ring

### INFORMATION

Two-way linear actuator connectors GN 134.1 are based on two-way connector clamps. The additionally provided mounting holes are used to connect to the drive key of a linear actuator.

The mounting holes  $d_3$  for the drive key are always located in the bore  $d_1$  or the square  $s_1$  in the one-axis system. Centering bushings in the through-hole eliminate the axial clearance. The width of the  $s_1$  square is dimensionally aligned with the play of the square linear actuators.

The clamping squares  $s_2$  are supplied not machined in the one-axis design.

For quick clamping without tools, the socket cap screws can be replaced by the adjustable hand levers GN 911 (see page 1874) listed in the table as accessories.

### ACCESSORY

- Adjustable Hand Levers GN 911 (see page 1874)

### TECHNICAL INFORMATION

- Plastic Characteristics (see page A2)
- Stainless Steel Characteristics (see page A26)

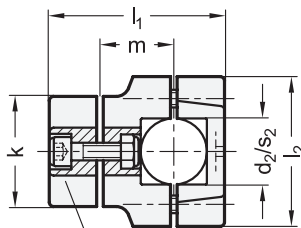

Socket cap screw /  
Hex nut

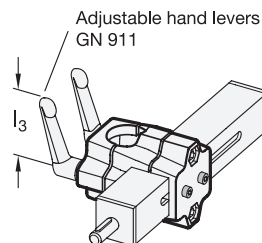
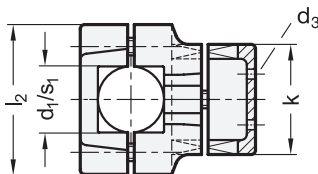
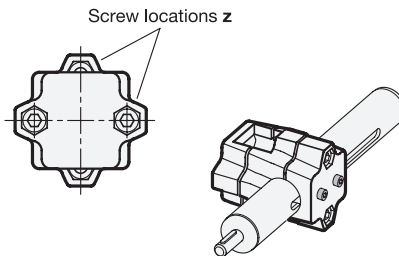

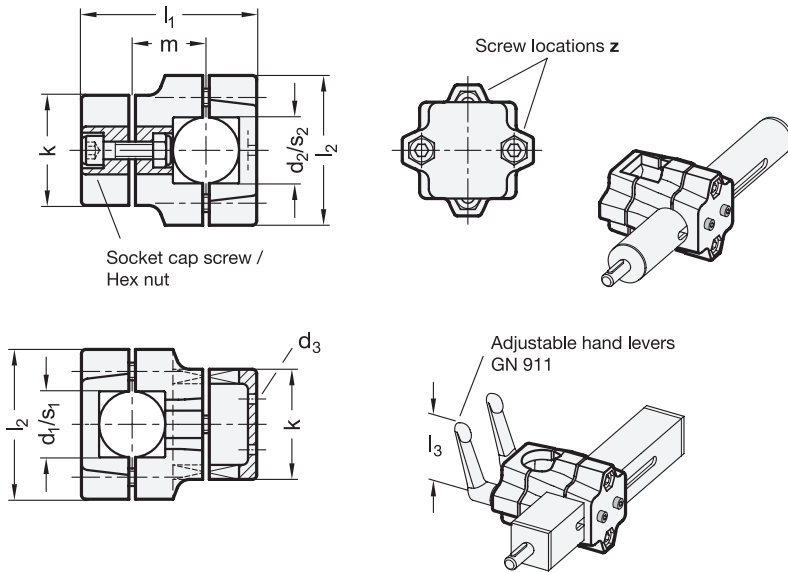

**GN 134.1**

Description	d1	d2	s1	s2	k Clamping length	d3	l1	l2	m	z Screw locations	Accessory Recom. hand lever GN 911 for z I3	
GN 134.1-B30-B30-50-2-S	B 30	B 30	-	-	50	M 4	79.5	68	33.5	M8-30	63   78	326
GN 134.1-B30-B30-60-2-S	B 30	B 30	-	-	60	M 4	109	79	50	M8-50	63   78	698
GN 134.1-B40-B40-60-2-S	B 40	B 40	-	-	60	M 5	109	79	50	M8-50	63   78	614
GN 134.1-B40-B40-76-2-S	B 40	B 40	-	-	76	M 5	125	98	55	M10-50	78   92	975
GN 134.1-B50-B50-76-2-S	B 50	B 50	-	-	76	M 6	125	98	55	M10-50	78   92	885
GN 134.1-B30-V30-50-2-S	B 30	-	-	V 30	50	M 4	79.5	68	33.5	M8-30	63   78	314
GN 134.1-B30-V30-60-2-S	B 30	-	-	V 30	60	M 4	109	79	50	M8-50	63   78	682
GN 134.1-B40-V40-60-2-S	B 40	-	-	V 40	60	M 5	109	79	50	M8-50	63   78	585
GN 134.1-B40-V40-76-2-S	B 40	-	-	V 40	76	M 5	125	98	55	M10-50	78   92	891
GN 134.1-B50-V50-76-2-S	B 50	-	-	V 50	76	M 6	125	98	55	M10-50	78   92	773
GN 134.1-V30-V30-50-2-S	-	-	V 30	V 30	50	M 4	79.5	68	33.5	M8-30	63   78	300
GN 134.1-V30-V30-60-2-S	-	-	V 30	V 30	60	M 4	109	79	50	M8-50	63   78	666
GN 134.1-V40-V40-60-2-S	-	-	V 40	V 40	60	M 5	109	79	50	M8-50	63   78	556
GN 134.1-V40-V40-76-2-S	-	-	V 40	V 40	76	M 5	125	98	55	M10-50	78   92	969
GN 134.1-V50-V50-76-2-S	-	-	V 50	V 50	76	M 6	125	98	55	M10-50	78   92	920

